

N93 Central gateway control unit

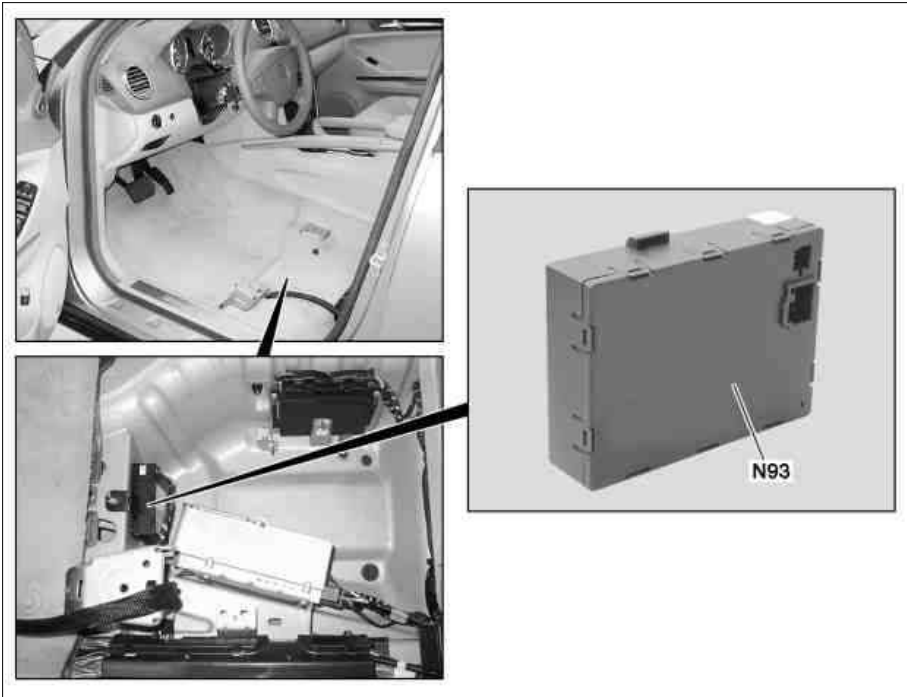

P54.21-2480-06

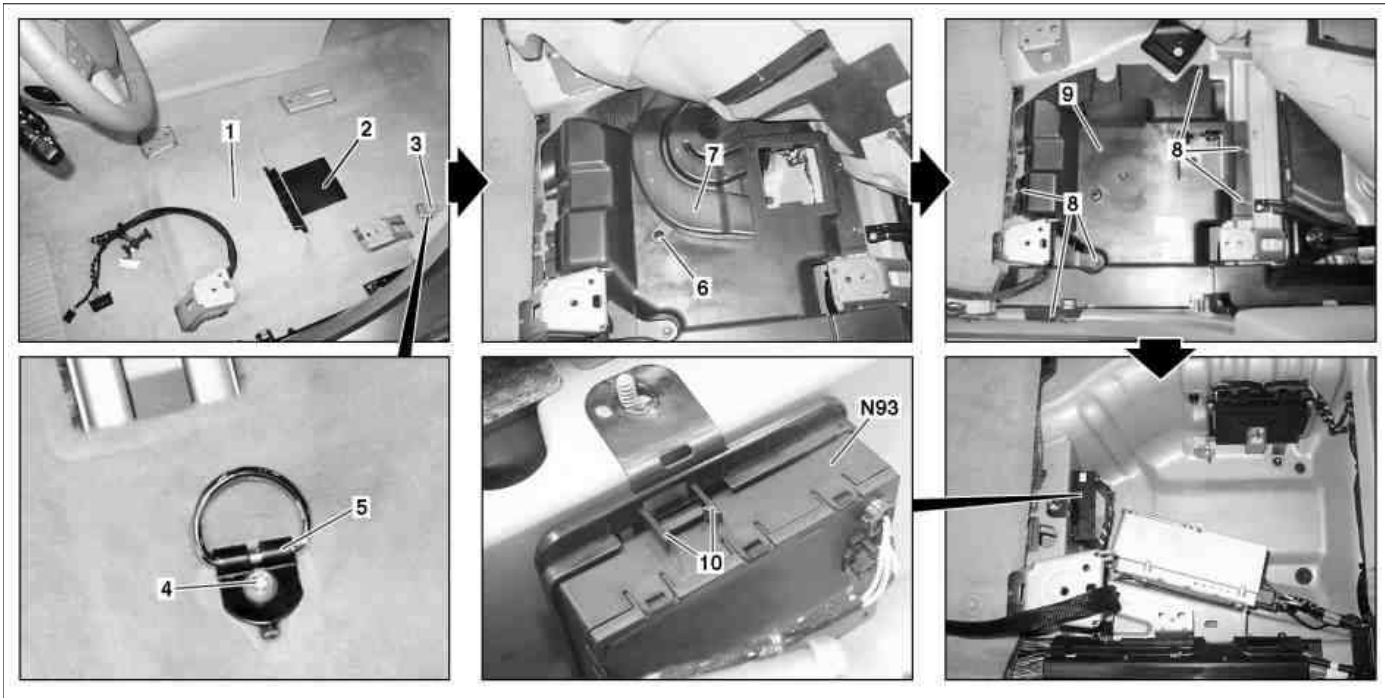



P54.21-2481-09

- | | |
|-----------------------|----------------------------------|
| 1 Rear floor covering | 7 Air duct |
| 2 Cover | 8 Nuts |
| 3 Anchoring lug cover | 9 Left intermediate bottom |
| 4 Bolt | 10 Catch lugs |
| 5 Anchoring lug | |
| 6 Clip | N93 Central gateway control unit |

Modification notes

25.7.06	Disconnect/connect battery ground line and carry out basic programming removed	Steps 2 and 17	
---------	--	----------------	--

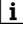
⚠	Remove/install		
⚠	Notes on avoiding damage to electronic components due to electrostatic discharge		AH54.00-P-0001-01A

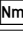
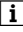
1	 Read out coding from central gateway control unit (N93) Connect STAR DIAGNOSIS and read out fault memory	 Only when replacing the central gateway control unit (N93) and if it can still be read out with STAR DIAGNOSIS. STAR DIAGNOSIS diagnosis system	AD00.00-P-2000-04A *WH58.30-Z-1048-13A
2	Remove left front seat		AR91.10-P-1000GZ
3	Remove left front entry trim		AR68.30-P-4100GZ
4	Remove left rear door sill molding		AR68.30-P-4100GZ
5	Remove lower trim on the left B-pillar		AR68.30-P-4700GZ
6	Remove cover (2).		
7	Remove anchoring lug cover (3)		
8	Remove bolt (4) and remove anchoring lug (5)	 Installation: Use anchoring lug (5) with its positioning lug properly. 	*BA68.50-P-1001-03F
9	Fold over rear left floor covering		
10	Remove clip (6) and remove air duct (7)		
11	Remove nuts (8) and remove left intermediate bottom (9)		
12	Separate electrical connectors from central gateway control unit (N93)		
13	Loosen central gateway control unit (N93) at the catch tabs (10) from the bracket and remove		
14	Install in the reverse order		
15	Code central gateway control unit (N93)	 Only when installing a new central gateway control unit (N93). STAR DIAGNOSIS diagnosis system	*WH58.30-Z-1048-13A

Cargo retainers

Number	Designation	Model 164.1/8
BA68.50-P-1001-03F	Bolt, cargo retainers to body Nm	24

Commercially available tools

Number	Designation
WH58.30-Z-1048-13A	STAR DIAGNOSIS diagnosis system, Compact Passenger Car 6511 1801 00